

# IMPORTANT SAFETY AND INSTALLATION INSTRUCTIONS

**WARNING:** Risk of fire and electric shock. This product is to be installed by a qualified electrician only.

**CAUTION:** When using electrical equipment, basic safety precautions should always be followed including the following: Read all instructions carefully before installation and save

for future use. Make sure installation and all connections are in accordance with National Electrical Code and any local regulations. To avoid possible electrical shock, be sure that power supply is turned off before installing or servicing this fixture. Servicing should be performed by qualified service personnel.

These instructions do not claim to cover all details or variations. When additional information is desired, please contact your SPI representative.

## INSTALLATION INSTRUCTIONS FOR IPS Ceiling Mount Page 1 OF 2

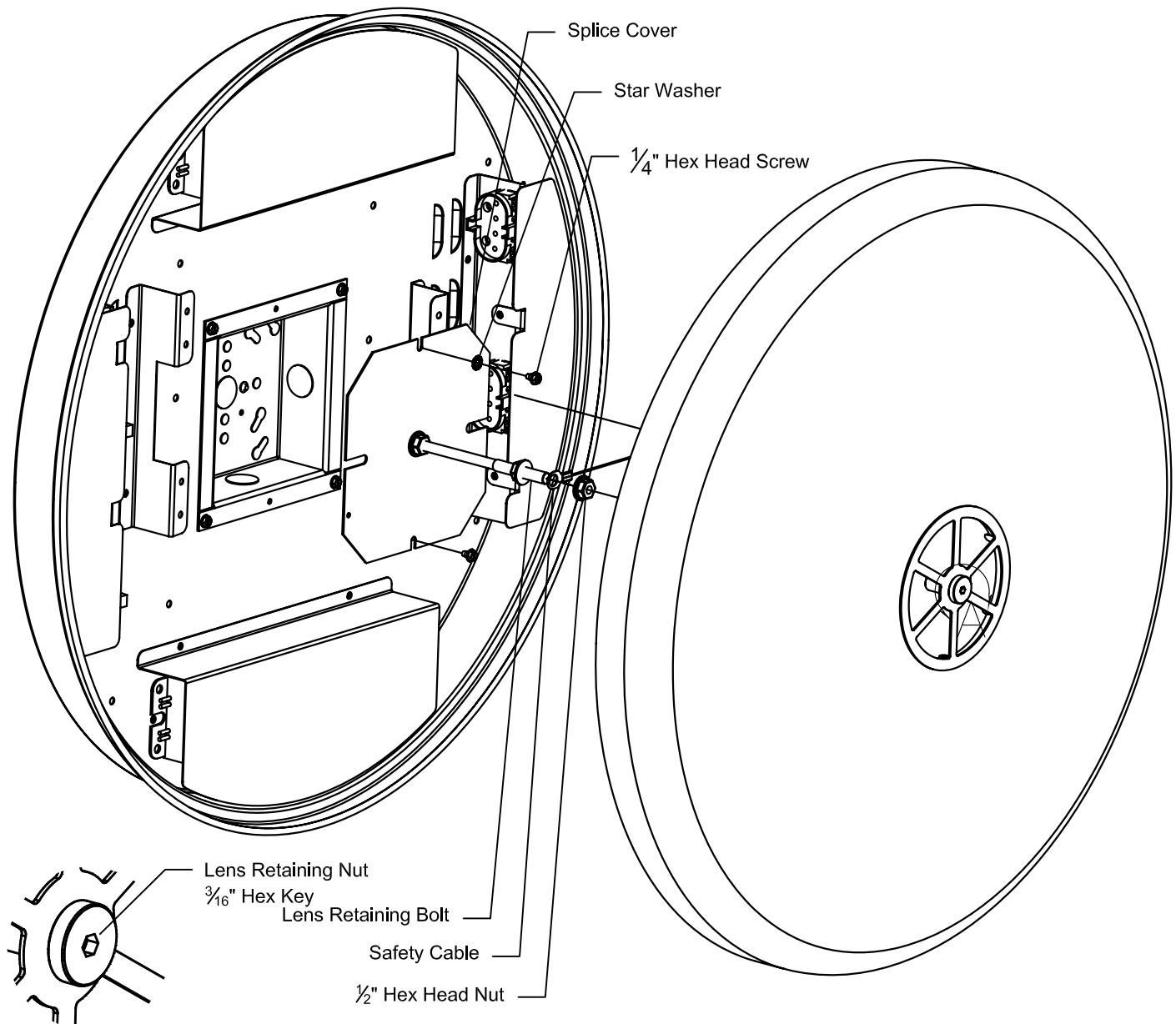

**FIGURE 1**

01/24/14  
IS40053X

# IMPORTANT SAFETY AND INSTALLATION INSTRUCTIONS

**WARNING:** Risk of fire and electric shock. This product is to be installed by a qualified electrician only.

**CAUTION:** When using electrical equipment, basic safety precautions should always be followed including the following: Read all instructions carefully before installation and save

for future use. Make sure installation and all connections are in accordance with National Electrical Code and any local regulations. To avoid possible electrical shock, be sure that power supply is turned off before installing or servicing this fixture. Servicing should be performed by qualified service personnel.

These instructions do not claim to cover all details or variations. When additional information is desired, please contact your SPI representative.

## INSTALLATION INSTRUCTIONS FOR IPS Ceiling Mount Page 2 OF 2

Before installing fixture, remove Lens (lens shape may vary from model shown) and splice cover.

Lens is removed by loosening the Lens Retaining Nut, as shown in Detail "A" with a  $\frac{3}{16}$ " hex key (Not Supplied).

Splice Cover is removed by loosening (2)  $\frac{1}{4}$ " hex head screws, as shown in figure 1.

Fixture is now ready to be installed on a J-Box or rigid conduit (by others). If fixture is purchased with optional mounting means, see Sheets 2 and 3.

**J-Box Mounting:** Remove mounting knock-outs on the fixture splice box associated with the field installed J-Box and  $\frac{7}{8}$ " conduit knock-out as shown in figure 2. If auxiliary mounting is required by code, remove auxiliary mounting knock-outs that align with field installed J-Box auxiliary mounting. Route lead wires from J-Box through conduit knock-out then secure fixture to J-Box with screws (by others) and ground wire to green ground screw inside fixture splice box. DO NOT PUSH SPLICES BACK INTO FIELD MOUNTED J-BOX. Reattach Splice Cover with supplied screws and start washer. STAR WASHER MUST BE USED FOR PROPER GROUNDING. When installing Splice Cover, care must be taken to route sleeved wires through slots in cover so it will attach properly and to avoid pinching wires.

**Rigid Conduit Mounting:** Remove  $\frac{7}{8}$ " conduit knock-out, as shown in figure 2. Route lead wires and conduit through knock-out then secure conduit to fixture. Splice lead wires to fixture wires with wire nuts (by others) and ground wire to green ground screw inside fixture splice box. Reattach Splice Cover with supplied screws and Start Washer. STAR WASHER MUST BE USED FOR PROPER GROUNDING. When reinstalling Splice Cover, care must be taken to route sleeved fixture wires through slots in cover so it will attach properly and to avoid pinching wires.

**Lamp Installation:** Align pins on lamp bases with receptacles in lamp sockets then push bases into sockets to engage lamps. Close lamp support clips over lamp tubes to securely hold lamps. Number of lamps depends on fixture ordered.

**Lens Attachment:** On the Lens Retaining Bolt, remove bottom  $\frac{1}{2}$ " Hex Head Flange Nut. If Lamp Shield option is purchased with Fixture see Sheet 3, Figure 10. Slip Ring from Safety Cable attached to lens over the retaining bolt and secure with nut, wrench tight. Reattach lens by tightening Lens retaining Nut attached to lens with  $\frac{3}{16}$ " hex key until snug. DO NOT OVERTIGHTEN

**Switching/Circuit Options:** Depending on fixture ordered, there may be Two Black leads and Two white leads in the Splice Box. For Single Circuit/Switch operation, connect both Black Fixture Leads to the Power Lead, and connect both White Fixture leads to the Common supply lead. For Separate Switching, connect both Common Fixture Leads to Common Supply Lead, and connect each Black Fixture Lead to respective Power Lead. For Dual Circuit, each Fixture Lead will be attached to its own Supply Lead.

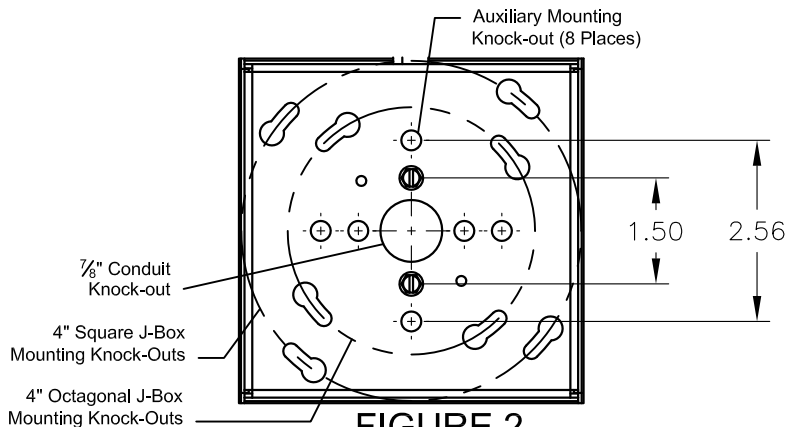

FIGURE 2

01/24/14  
IS40053X